



RELIABILITY BUILT IN™

www.tsbrass.com

T&S Brass Water and Energy Conservation

Stop the Leaks! Conserve Water and Energy

Troubleshooting Tips and T&S Repair and Replacement Parts

A leaky faucet that drips at the rate of one drip per second can waste more than 3,000 gallons per year. That translates into substantial money and resource losses. Water shortages and conservation are hot topics, especially in the plumbing

industry, and everyone knows that a leaky faucet is both a financial and environmental waste.

We at **T&S** take great pride in the products we sell. But even the highest quality faucets on the market eventually need repair.

This handout shares a few tips for troubleshooting your **T&S** faucet or pre-rinse units.

If you need it in a hurry, as always we offer our speedy **Quick-Ship 24-Hour shipping** to your door.



T&S Faucets Using Eterna Compression Cartridges

Aerator or Rosespray leak here? The O-ring between the outlet tip and nozzle needs replacing: (#001048-45 – swing nozzles) (#001043-45 – rigid goosenecks)

Leaking at base of Bonnet? The Top Gasket is worn out (#002601-45).

Leaking at Coupling Flange? the Coupling Gasket needs replacing (#001019-45).

Leaking around Handle? Worn Packing needs replacing. Remove Bonnet Nut to replace (#001098-45).

Leaking at Nozzle base? Swivel O-Ring needs replacing (#001074-45).

Leaking here? It's likely the Seat Washer at the bottom of the Spindle is worn and needs replacing. If leak doesn't stop, the Seat may be damaged and need replacing. Also, check Spindle and Bottom Gasket for damage and replacement.

Where's The Leak?

T&S Pre-Rinse Units and Spray Valves

Broken Hose? (B-0044-H; other sizes are available).

A leak here means the Hose Washer needs replacing (#001014-45).

Leaking at base of Handle? Washer needs replacing (#010476-45).

Leak here? Replace Rubber Bumper (B-24K*).

Drippy leak here? Replace Bonnet assembly (#002856-40).

*B-24K kit replaces spray face and rubber bumper

T&S "Cerama" Ceramic Cartridges (-CR) are water-saving options available for many of our pre-rinse units and faucets. Look for our **-C and -CR series** pre-rinses and faucets. Using the **T&S Cerama Cartridge helps save, on average, approximately 5.5 GPM*** over a standard compression cartridge on a dual temperature faucet.



Cartridge Comparison Standard Compression Cartridge and T&S Cerama Cartridge*

Standard Compression (not 1/4 turn):

40 psi to both inlets = 18.06 GPM
60 psi to both inlets = 23.67 GPM

T&S Cerama Cartridge (1/4 turn):

40 psi to both inlets = 12.73 GPM
60 psi to both inlets = 17.12 GPM

* Data from testing B-0230 faucet with standard 18" nozzle, with index tip (screen outlet), no aerator

How Can You Conserve Water and Energy FAST?

Water Conservation Comparison Chart Standard Spray Valve and B-0107-C Spray Valve

Assumptions:

- 15 minutes/hour x 10 hours/day x 6 days/week x 50 weeks/year = 45,000 minutes/year
- Water supplied at 60 PSI

A Standard spray valve flows 4.25 GPM at 60 PSI, 140°F; B-0107-C spray valve flows 0.65 GPM at 60 PSI, 140°F, SAVING 3.60 GPM

Water Savings Per Year using B-0107-C Low Flow Spray Valve vs. Standard Spray Valve:

45,000 min/year x 3.60 GPM = 162,000 gal/year
SAVED

Summary of Flow Testing: Standard Spray Valve and B-0107-C:

Inlet Pressure	Standard Spray Valve	B-0107-C Low Flow S.V.
60 PSI	4.25 GPM	0.65 GPM

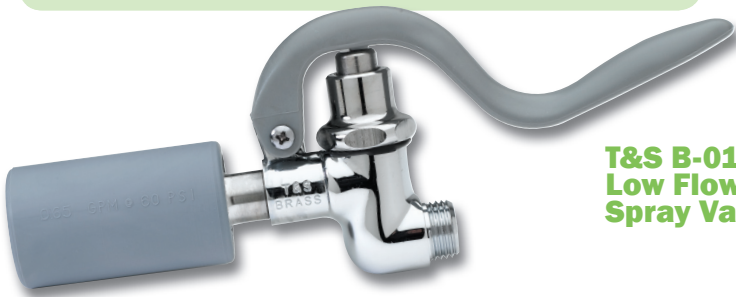

**T&S B-0107-C
Low Flow
Spray Valve**

NOTES

T&S Eterna and Cerama Cartridges

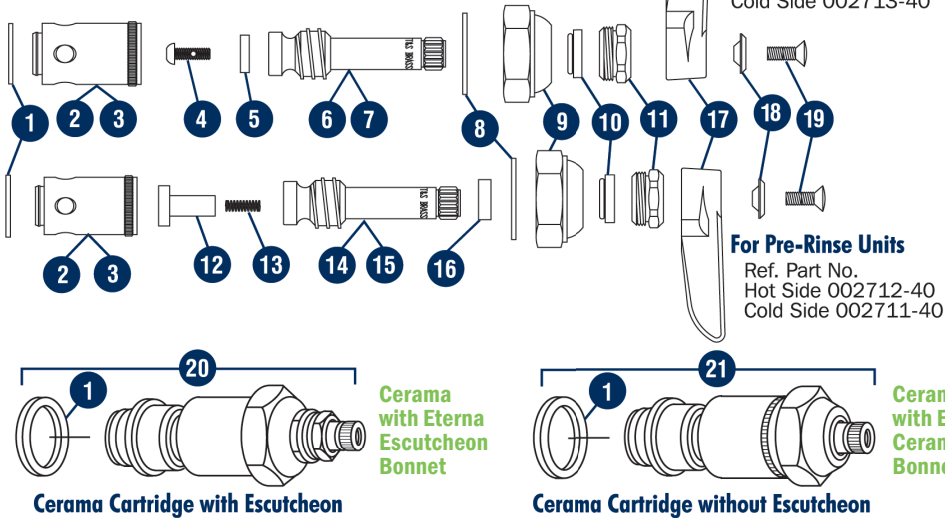

- 1 001022-45 Bottom Gasket
- 2 000788-20 Removable Insert (Hot) 64L
- 3 000789-20 Removable Insert (Cold) 66L
- 4 000933-45 Seat Screw
- 5 001092-45 Seat Washer
- 6 000811-25 Spindle (Hot) 18L
- 7 000812-25 Spindle (Cold) 16L
- 8 002601-45 Top Gasket
- 9 009744-45 Bonnet
- 10 001098-45 Bonnet Seal Packing
- 11 000718-25 Packing Nut
- 12 003164-45 Spring Check Seat
- 13 001479-45 Spring
- 14 001907-25 Spindle (Hot) 264L
- 15 001908-25 Spindle (Cold) 263L
- 16 001466-20 Quarter Turn Sleeve
- 17 001638-45 Lever Handle (Blank)
- 18 001637-45 Lever Handle (Hot)
- 19 001636-45 Lever Handle (Cold)
- 20 001661-45 Index, Red (Hot)
- 21 001660-45 Index, Blue (Cold)
- 000922-45 Lever Handle Screw
- 011616-25 Hot
- 011617-25 Cold
- 011618-25 Hot with Check Valve
- 011619-25 Cold with Check Valve
- 011278-25 Hot
- 011279-25 Cold
- 012394-25 Hot with Check Valve
- 012395-25 Cold with Check Valve



T&S Brass and Bronze Works, Inc.

2 Saddleback Cove • Travelers Rest, SC 29690 • Phone (800) 476-4103 • Fax (800) 868-0084

West Coast Sales and Distribution • 4596 Ish Drive, Unit 220 • Simi Valley, CA 93063 • Phone (800) 423-0150